

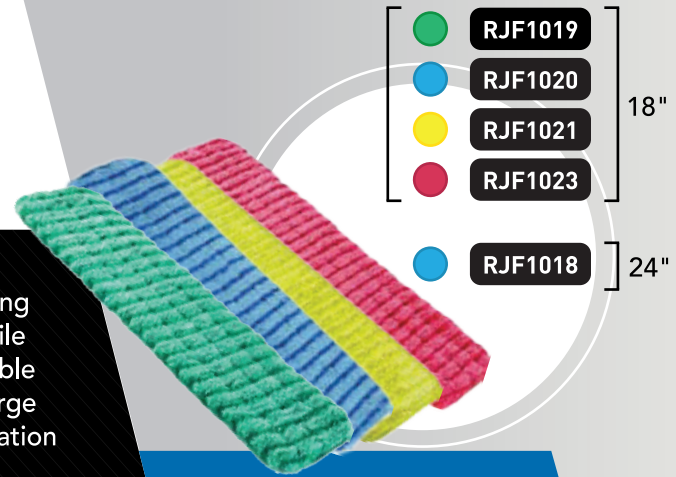

# 18" & 24" | Microfiber Scrubber Mop Heads

These microfiber scrubber mop heads are engineered for commercial floor care applications requiring both agitation and absorption. Featuring a dual-surface design, the scrubber edge helps loosen stuck-on soil while the microfiber body efficiently captures dirt, dust, and moisture. Available in 18" and 24" sizes, they support flexible cleaning strategies across large and small floor areas. Color-coded options help reduce cross-contamination and support organized cleaning programs.



**Color-Coded | Low-Lint, Dry or Damp Cleaning | Washable & Reusable**

## Product Features

- Dual-action microfiber construction for scrubbing & absorption
- Available in 18" and 24" sizes for versatile floor coverage
- Color-coded options (blue, yellow, green, red) to support zone cleaning
- High-capacity microfiber for effective dirt and liquid pickup
- Designed for repeated laundering without performance loss
- Compatible with standard commercial flat mop frames

## Multi-Applications



Hospitality and Food-Service Prep Areas



Corporate and Administrative Offices



Light-Industrial and MRO Workspaces



Healthcare Buildings



Government Buildings



Education Facilities

## Product Specs

|             | RJF1019, RJF1020, RJF1021, RJF1023 | RJF1018                    |
|-------------|------------------------------------|----------------------------|
| Material    | 80% Polyester   20% Polyamide      |                            |
| Color       | 19 Green 20 Blue 21 Yellow 23 Red  | 18 Blue                    |
| Size        | 18 x 5 x 0.5 in                    | 24 x 5 x 0.5 in            |
| Weight      | 0.165 Lbs (75g)                    | 0.209 Lbs (95g)            |
| Packaging   | 12 pcs/pack   8 packs/case         | 12 pcs/pack   8 packs/case |
| Pack Size   | 19.29 x 12.99 x 1.97 in            | 18.5 x 8.5 x 12.5 in       |
| Pack Weight | 2 Lbs                              | 2.61 Lbs                   |
| Case Size   | 20.08 x 13.19 x 16.14 in           | 25.2 x 14.96 x 12.2 in     |
| Case Weight | 18 Lbs                             | 22.31 Lbs                  |

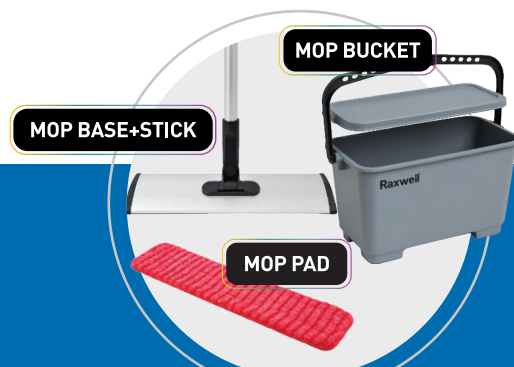

### RAXWELL MICROFIBER MOP SYSTEM

A complete microfiber floor-care system engineered to clean faster, reduce labor, and support reusable pad performance across high-traffic environments.

**Bulk Discount Available!**

949.528.3572 | [info@raxwellinc.com](mailto:info@raxwellinc.com) | [www.raxwellinc.com](http://www.raxwellinc.com)

